



Flow switch assembly

The Signet Flow Switch Kit provides a level of protection and a sense of security to automated processes by protecting against accidental or overdosing of disinfectant solutions such as Chlorine, Sodium Hypochlorite, or Chlorine Dioxide into a system when flow has been interrupted. The flow switch interrupt provides cost saving on chemicals and could also prevent damage to the piping system. It is factory set to deactivate/open when flow levels inside the flow cell drop below 0.378 lpm (0.1 gpm) which removes the supply power to the chemical dosing pumps.

The flow switch kit is easily installed into the 4630 Chlorine Analyzer System's flow cell, and wires into the electrical box in less than 15 minutes. The kit comes complete with a DIN rail mount, 10 amp relay, two terminal connectors, flow switch assembly and corrosion resistant flex conduit and cable glands.

## Features

- Saves chemicals cost
- Prevents chemical dosing when flow is interrupted
- Mounts directly into the 4630 flow cell
- Interrupts power to the 8630-3P mechanical relays

## Applications

### Residual Chlorine Monitoring:

- Water Distribution
- Ground Water
- Surface Water
- HVAC Applications (cooling water)
- Gray Water Dechlorination
- Food and Beverage
- RO Membrane Protection
- Swimming Pools
- Aquariums
- Water Parks

## System Overview

Flow Switch Kit

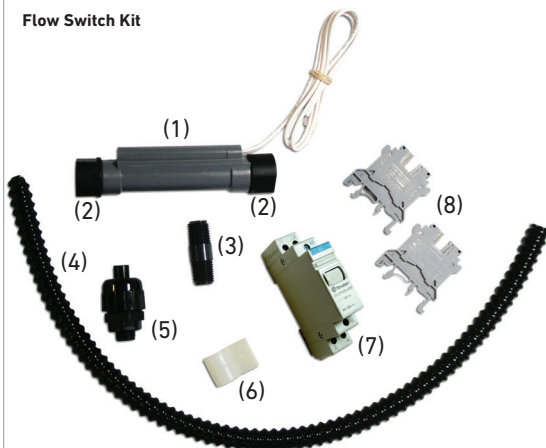

- |   |                        |
|---|------------------------|
| 1 - Flow switch (1)   | } Flow switch assembly |
| 2 - End adapter (2)   |                        |
| 3 - Threaded PVC nipple 1/4" (pre-assembled into flow switch) (1) |                        |
| 4 - Liquid-tight flex conduit (1)                                 |                        |
| 5 - Liquid-tight fitting 1/4" (1)                                 |                        |
| 6 - Adhesive-backed nylon clamp 1/2" (1)                          |                        |
| 7 - Relay (1)   |                        |
| 8 - DIN-rail terminal (2)   |                        |

# Specifications

General					
Compatibility		3-4630-XX Free Chlorine Analyzer System			
Flow Switch					
	Material	Polypropylene Body			
	Switch Type	Reed			
	Contact Rating	70 VA, 50 w resistive			
	Maximum Switching Voltage	AC	300	DC	350
	Maximum Switching Current	AC	0.5 amps	DC	0.7 amps
Mechanical relay					
	Relay Type	General purpose			
	Coil Voltage VDC Nom.	24 VDC			
	Contact Current Max.	10 AMP			
	Contact Voltage AC Nom	250 V			
	Contact Configuration	DPDT			
Shipping Weights					
		0.05 kg	0.12 lb		
Standards and Approvals					
		Standards and approvals vary depending on the component. Refer to the instruction sheet for more information			

# Dimensions

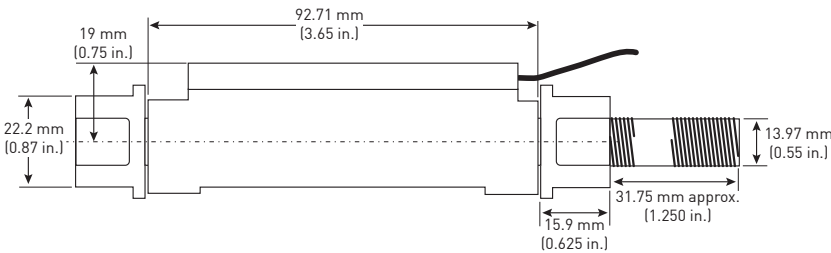

# Ordering Information

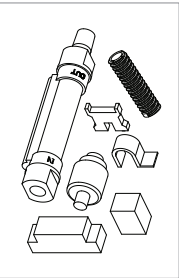

Mfr. Part No.	Code	Description
3-4630.393	159 310 162	Flow Switch Kit, PP

Contact the factory and use the following for pricing information